

### SUPPLIED FIXING KIT

DESC	QTY
M8X20mm BOLT	8
M8 NYLOC NUT	8
M8 WASHER	16
M6 WASHER	4
M6 BOLT	4

### SUPPLIED COMPONENTS

#	DESC	QTY
1	RRP112	1L, 1R
2	RRP114	1L, 1R
3	RRP129	4
4	SP1 NUT	4
5	D BAR	2
6	25mm FOAM	400mm

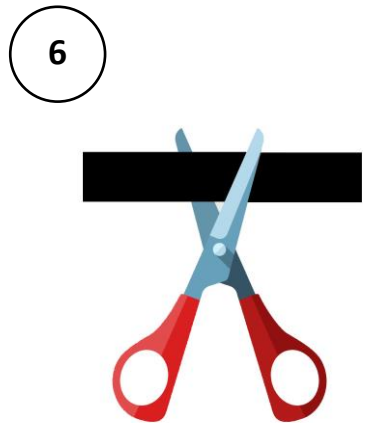
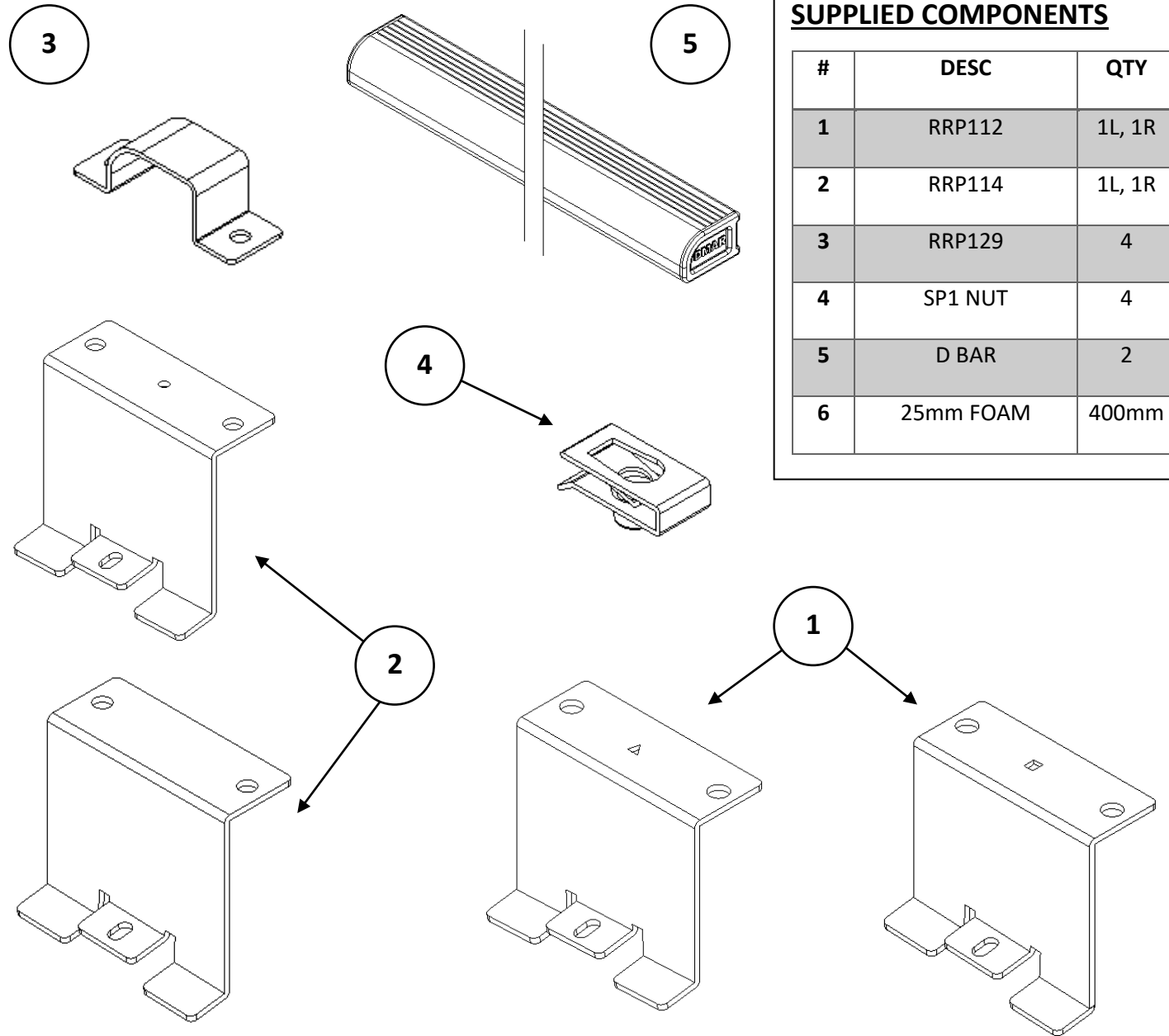

Cut the foam to 3cm lengths and stick to the feet of the RRP112 and RRP113.

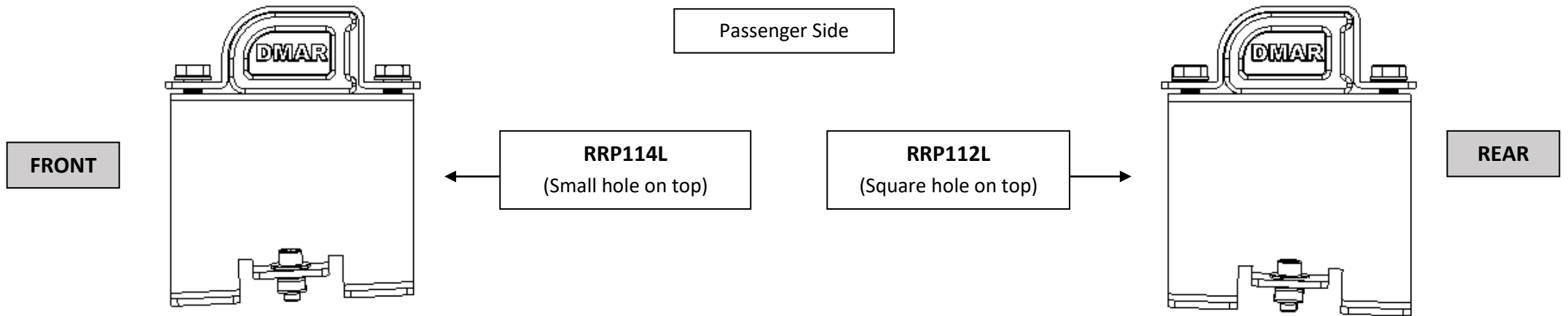
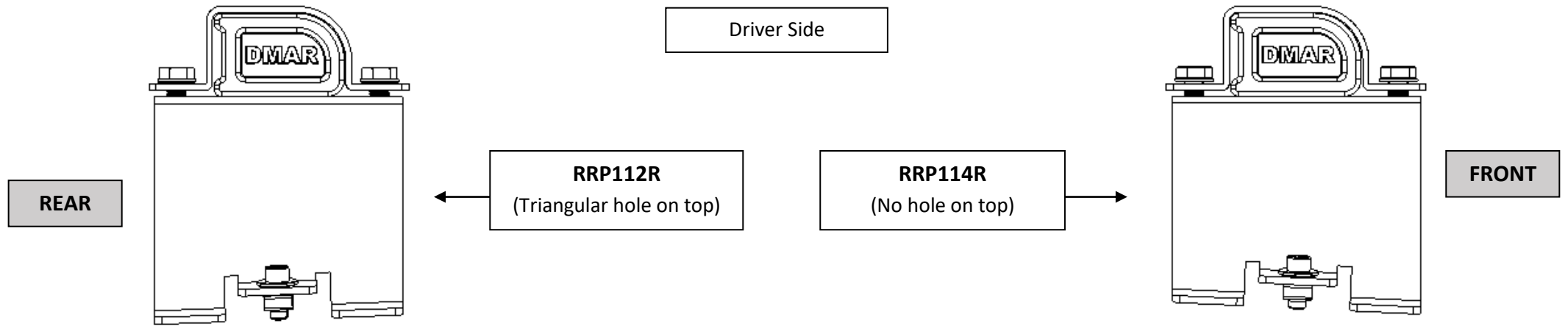

Slide the SP1 nut into the pockets on the roof

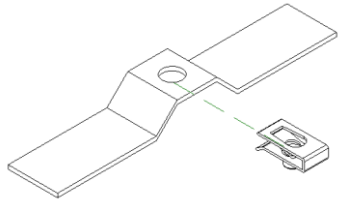

Bolt the RRP129 to the top of the RRP brackets.  
Leave all nuts finger tight at the moment.

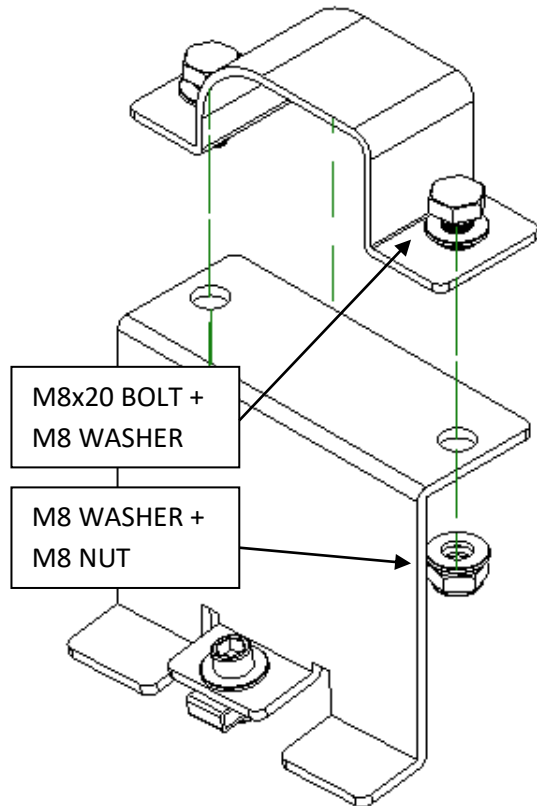

Press down hard to compress the foam. Use an Allen key to tighten bolt to the roof.

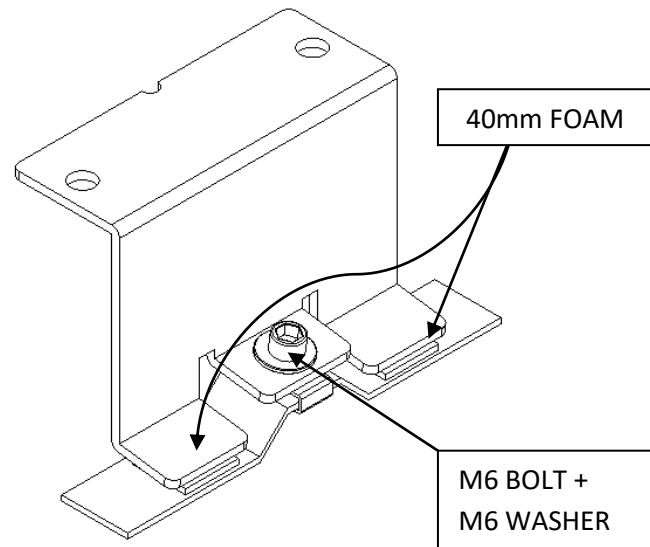

Slide the bar in position and make sure it is centrally positioned. At this stage, all nuts and bolts can be tightened.

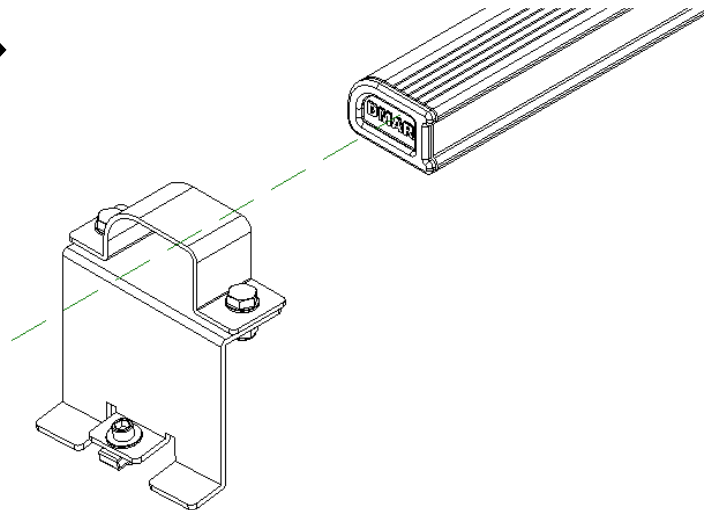

Once in position, tighten all fixings to **8Nm**.  
Periodically check all fixings.



NOTES: Do not exceed vehicle manufacturers roof loading recommendations. Loads must be evenly distributed. All fixings and clamps need to be checked regularly for fatigue or wear and tightened or replaced when required. Paint damage to be touched up to prevent corrosion occurring. No liability is accepted by DEMAR for damage to vehicle or claims arising from use of roof rack. User must ensure all Health and Safety recommendations are complied.

